

EXC-138SDF CARTON SEALER SIDE DRIVE & TOP FLAP CLOSURE



FEATURES

- **Easy manual adjustment for height and width of cartons**
- **Four flap closure automatically**
- **Quick tape head removal for easy tape reel change**
- **Adjustable conveyor working height with measurement scale**
- **Safety Guards with interlocked access doors**
- **Safety emergency stop**
- **Versatile carton sealing machine, which can be wheeled to the work area required**
- **Backed by our comprehensive range of spares and fully trained service technicians**

OPTIONS:

Tape Head:	75mm
Indexing Stopper:	Spaces cartons
Infeed:	Roller Conveyor
Outfeed:	Roller Conveyor
Tape out Detector:	A flashing light indicates the tape has run out.
Cushion Side Belts:	The side belts are spring loaded for bulging cartons. This allows smooth transfer and correct taping.

EXC-138SDF

CARTON SEALER

SIDE DRIVE & TOP FLAP CLOSURE

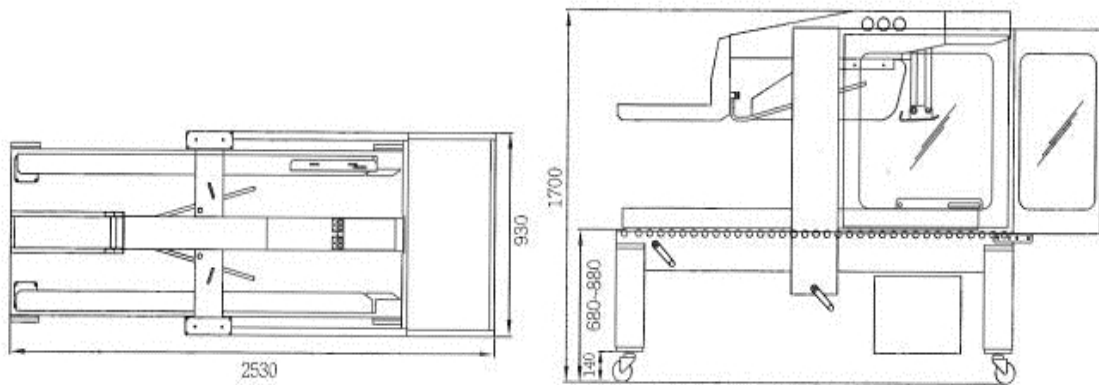

SPECIFICATIONS:

Tape:	Standard 36mm, 48mm wide
Speed:	23m/minute
Capacity:	(L) 120mm ~ 610mm (W) 110mm ~ 500mm (H) 120mm ~ 500mm
Voltage:	240V single phase, 10Amp
Consumption:	450w
Compressed Air:	6kg/cm ³ 33 L/min.
Machine Size:	1960mmL x900mmW x1680mmH
Machine Net Weight:	300KG

All Specifications are subject to change.